



## INSTRUCTIONS:

### Storing the Chicco Car Seat in the Car Seat Travel Bag

IMPORTANT: Please also refer to the instructions that came with your product.

SS0036E\_02

#### INFANT CAR SEATS:

The following instructions are for all Chicco Infant Car Seats (KeyFit, KeyFit 30, KeyFit 35, Fit2).

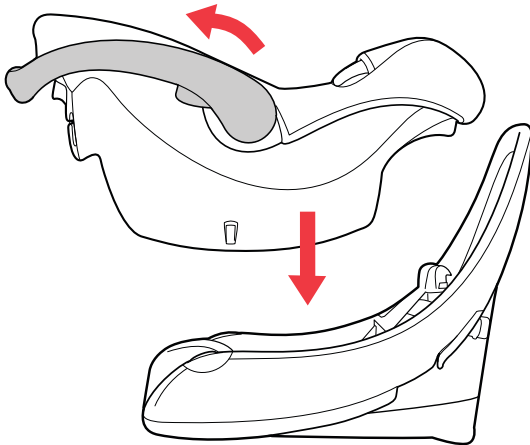

- ① **Attach the Car Seat to the Base** and position the Carry Handle and Canopy, as shown. If storing the **Fit2** Car Seat make sure base is in **Stage 1** position.

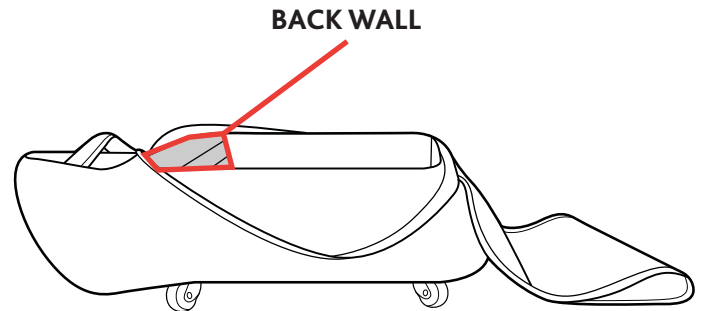

- ② **Fold back the fabric of Travel Bag**, making sure that the Back Wall is uncovered.

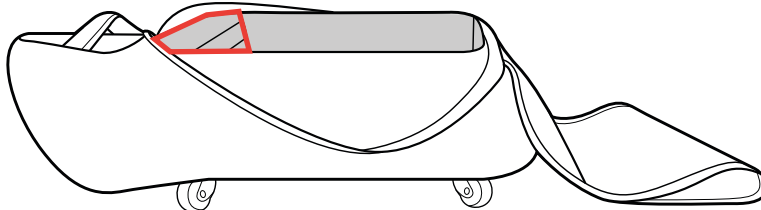
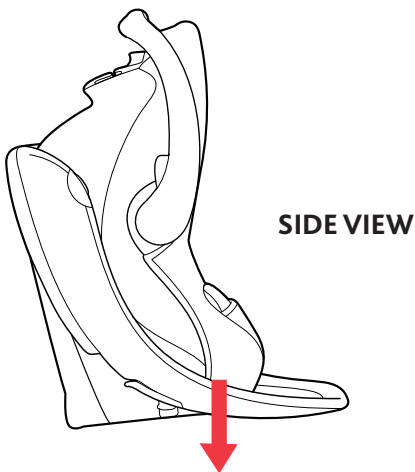

- ③ **Insert the Car Seat and Base into the Travel Bag**, as shown. Make sure that the Base sits flat against the bottom of the Travel Bag and is **NOT** resting on top of the Back Wall.

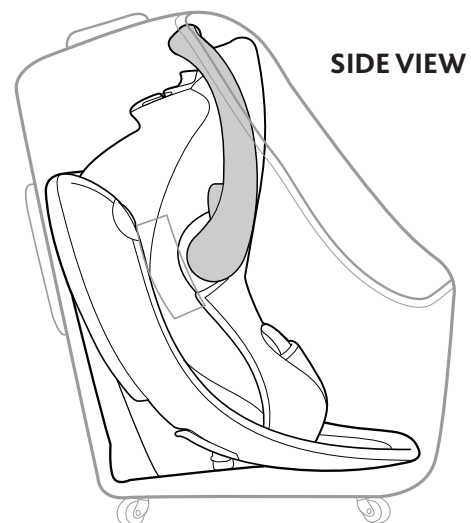

- ④ **Make sure the Carry Handle is NOT in a locked position** and bring the fabric up and around the Base and Car Seat and zip up the Travel Bag.

## **CONVERTIBLE / ALL-IN-ONE / HARNESS + BOOSTERS:**

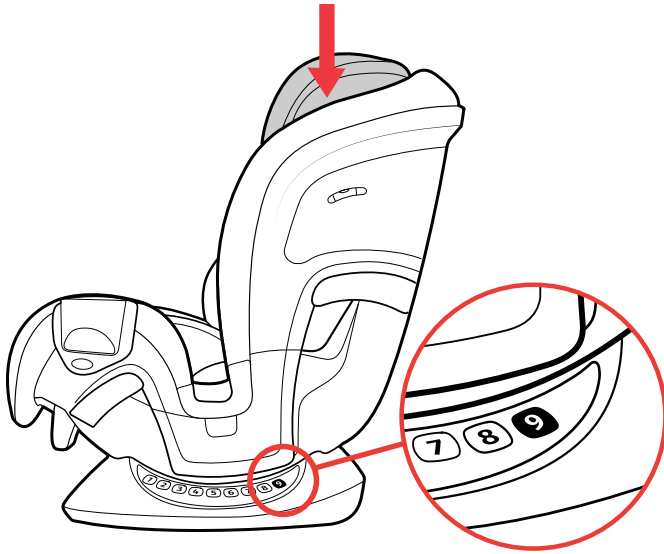

**1** Incline the Car Seat to the most upright position and lower the Headrest into the lowest position.

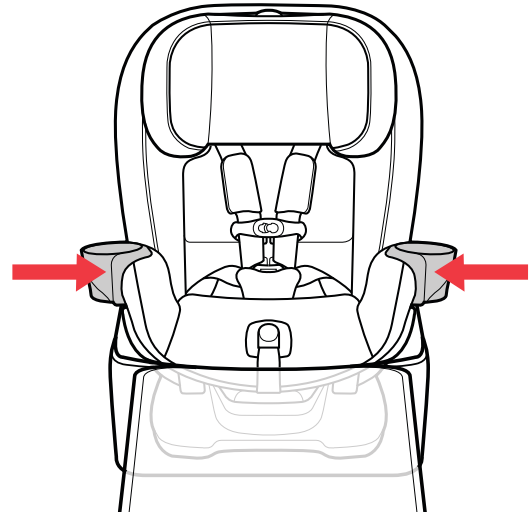

**2** Insert the Car Seat into the Travel Bag and push in both Cup Holders, as shown.

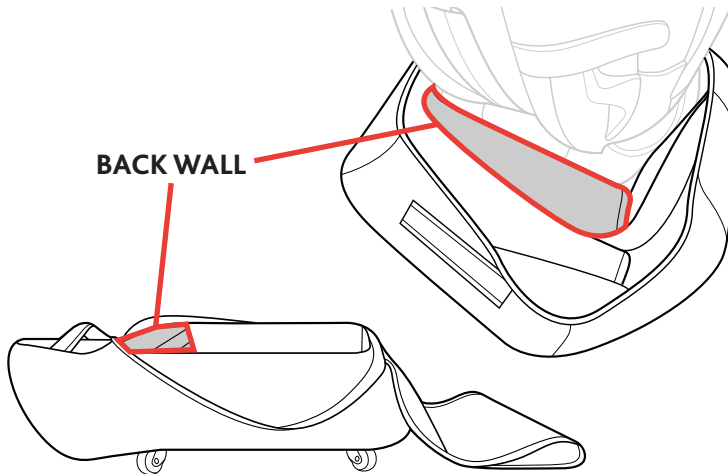

**3** Make sure that the bottom of the Car Seat sits flat against the bottom of the Travel Bag and is **NOT** resting on top of the Back Wall of the Travel Bag.

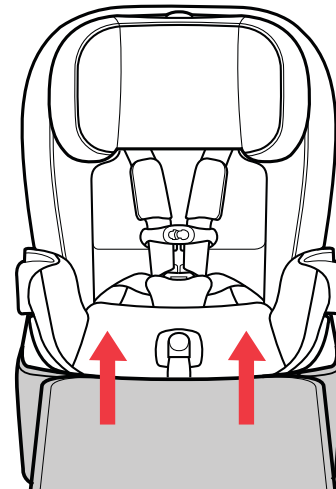

**4** Lift front of Car Seat Travel Bag up over the front of Car Seat.

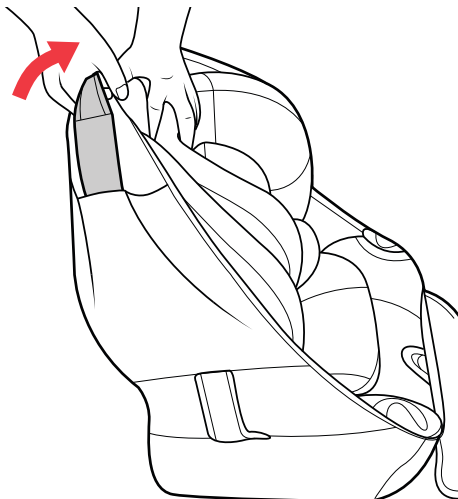

**5** Use Car Seat Travel Bag Handle to lift Car Seat Bag over top of the Car Seat

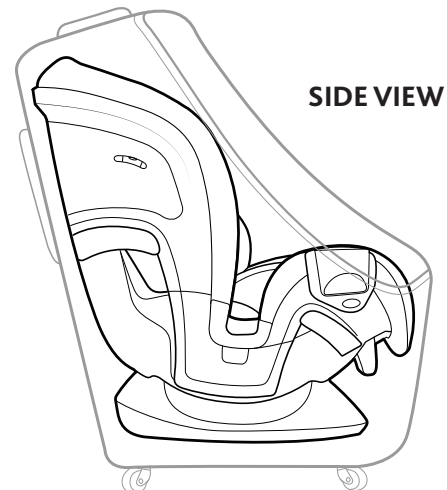

**6** Bring the fabric up and around the Car Seat and zip up the Travel Bag.

## Fit360:

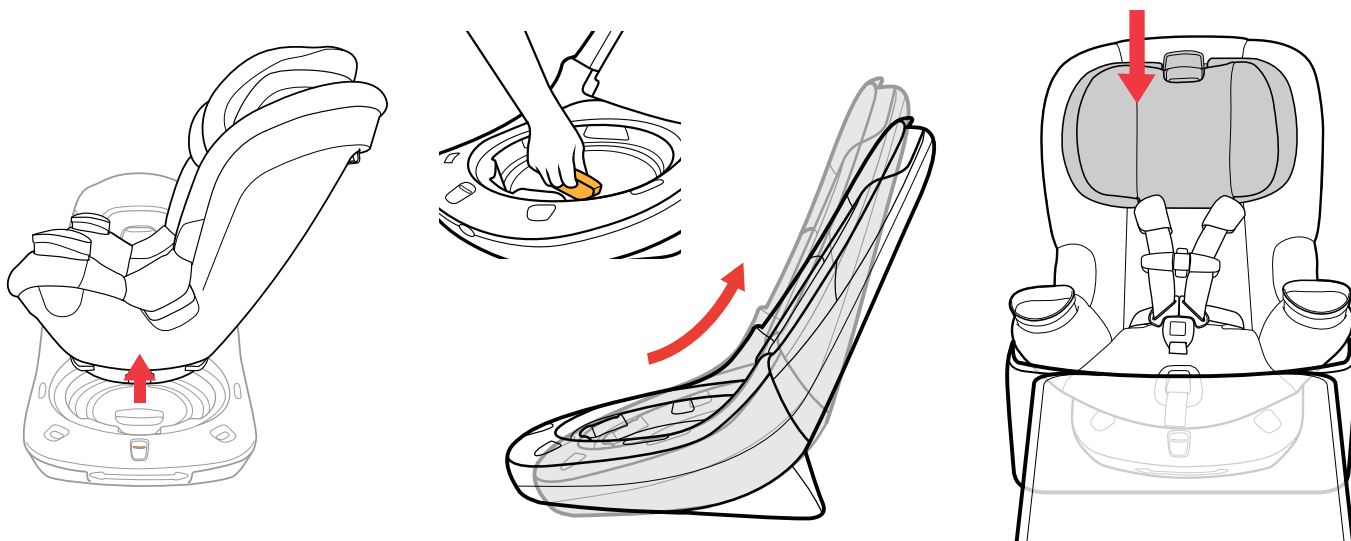

❶ Remove the seat from the Base, incline the Base to the most upright position. Reattach the seat to the Base. Lower the Headrest into the lowest position and Insert the Car Seat into the Travel Bag.

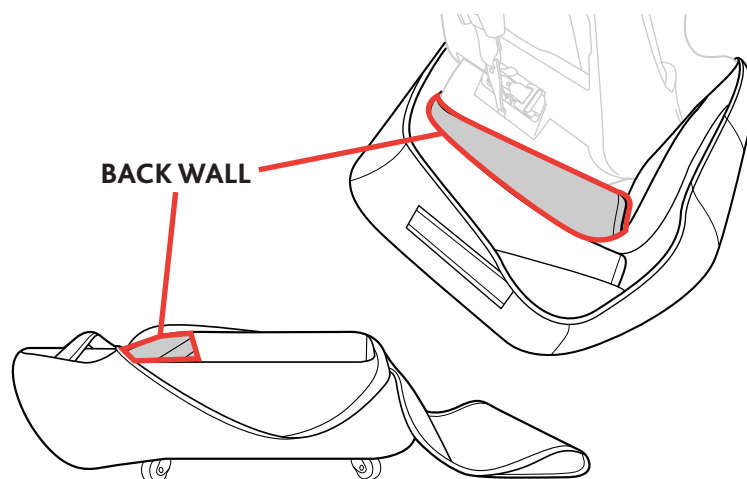

❸ Make sure that the bottom of the Car Seat sits flat against the bottom of the Travel Bag and is NOT resting on top of the Back Wall of the Travel Bag.

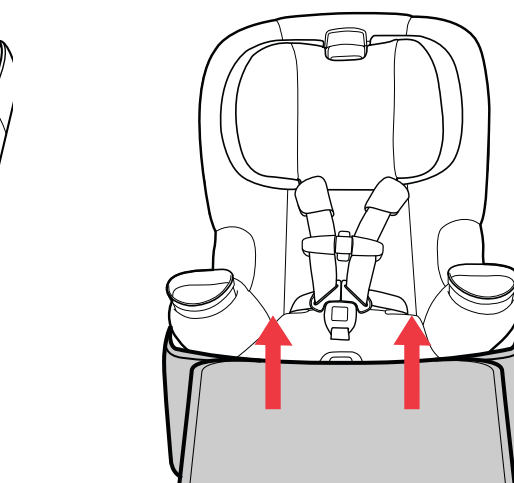

❹ Lift front of Car Seat Travel Bag up over the front of Car Seat.

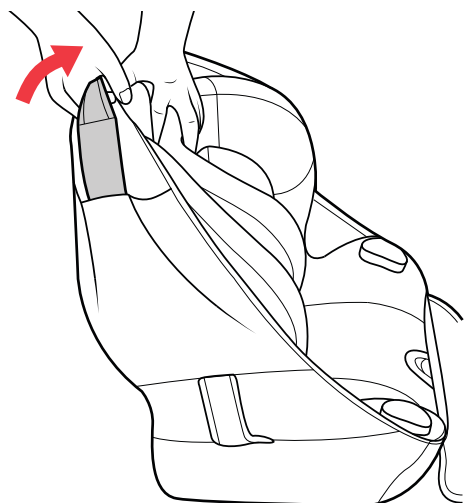

❺ Use Car Seat Travel Bag Handle to lift Car Seat Bag over top of the Car Seat

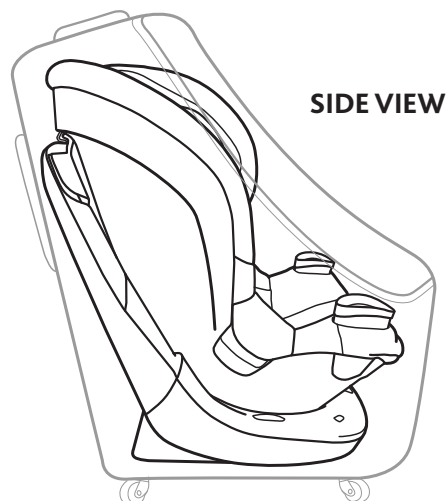

❻ Bring the fabric up and around the Car Seat and zip up the Travel Bag.

## **BELT POSITIONING BOOSTERS:**

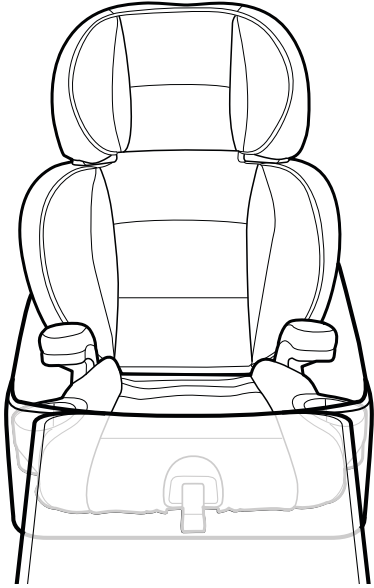

**1** Insert the **Booster Car Seat** into the **Travel Bag**, as shown. Make sure that the bottom of the **Booster Car Seat** sits flat against the bottom of the **Travel Bag** and the **Booster Headrest** is placed into the lowest position.

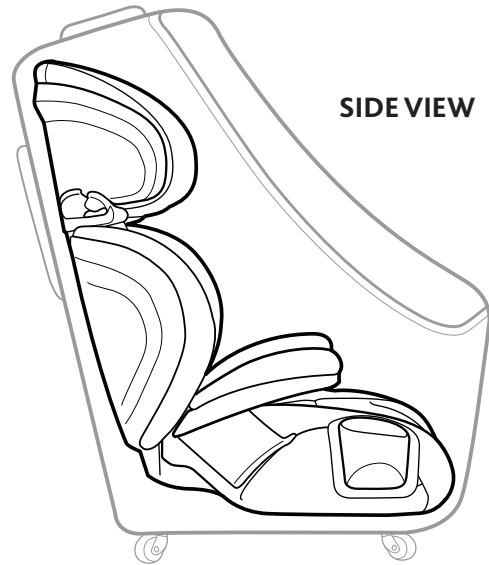

**2** Bring the fabric up and around the **Booster Car Seat** and zip up the **Travel Bag**.