



Read all instructions **BEFORE** assembly
and **USE** of product.

KEEP INSTRUCTIONS FOR FUTURE USE.

ALFA LITE[®] NEST

Portable Playard and Bassinet

BASSINET WARNINGS

WARNING

DEATH or SERIOUS INJURY CAN OCCUR

FAILURE TO FOLLOW THESE WARNINGS AND THE INSTRUCTIONS
COULD RESULT IN DEATH OR SERIOUS INJURY.

SUFFOCATION HAZARD

Babies have suffocated:

- On pillows, comforters and extra padding.
- In gaps between a wrong size mattress, or extra padding and product sides.
- **NEVER** add soft bedding or padding.
- Use **ONLY** the mattress provided by Chicco.
- **ALWAYS** place baby on back to sleep to reduce the risk of SIDS and suffocation.

STRANGULATION HAZARD

Children have **STRANGLED** when their necks became trapped between accessories and play yard frames.

- **Strings can cause strangulation!**
DO NOT place items with a string around a child's neck such as hood strings or pacifier cords. **NEVER** suspend strings over product or attach strings to toys.
- If a sheet is used with the pad, use only the one provided by the product manufacturer or one specifically designed to fit the dimension of the product mattress
- **Remove the bassinet anytime the child is in the playard.**

FALL HAZARD: To prevent falls

- **DO NOT** use this product when the infant begins to push up on hands and knees or weighs over 15 lbs (6.8 kg), whichever comes first.
- Child can become entrapped and die when improvised netting or covers are placed on top of product. Never add such items to confine child in product.
- **DO NOT** place more than one child in bassinet or playard.

OTHER HAZARDS:

- **DO NOT** move or fold bassinet with child in it - child could be injured.
- Keep Playard with Bassinet away from stoves, heaters, fireplaces and other hazards which can cause injury to your child.
- For indoor use only.

When using the Alfa Lite Nest as a PLAY AREA with DOOR UNZIPPED:

- **NEVER** leave child unattended.
- You must first prepare the surrounding area and make sure it is safe.
- **ALWAYS** keep this product away from and guard against hazards that may injure your child.

PLAYARD WARNINGS

WARNING

DEATH or SERIOUS INJURY CAN OCCUR

FAILURE TO FOLLOW THESE WARNINGS AND THE INSTRUCTIONS
COULD RESULT IN DEATH OR SERIOUS INJURY.

SUFFOCATION HAZARD

Babies have suffocated:

- On pillows, comforters and extra padding.
- In gaps between product sides and a wrong size mattress, or extra padding
- **NEVER** add soft bedding, padding, or an extra mattress.
- **ONLY** use the mattress as described in the warnings on this product.
- Use **ONLY** mattress/pad provided with this product or contact Chicco for a replacement mattress/pad.
- **NEVER** leave child in product with side lowered. Be sure side is in raised and locked position whenever child is in product.
- **NEVER** use plastic shipping bags or other plastic film as mattress covers not sold and intended for that purpose. They can cause suffocation..
- **NEVER** use a water mattress with this product.

OTHER HAZARDS:

- Keep playard away from stoves, heaters, fireplaces and other hazards which can cause injury to your child.
- **DO NOT** move or fold playard with child in it - child could be injured.
- For Indoor use only.
- **DO NOT** use the floor pad without the boards properly installed.

- The product, including side rails, **MUST** be fully erected with all 4 legs locked into position and secured prior to use.
- Make sure latches are secure.
- **Strings can cause strangulation!**
NEVER place items with a string around a child's neck such as hood strings or pacifier cords. **NEVER** suspend strings over product or attach strings to toys.
- **NEVER** place product near window where cords from blinds or drapes can strangle a child.
- Child can become entrapped and die when improvised netting or covers are placed on top of product. **NEVER** add such items to confine child in product.
- When child is able to pull to a standing position, remove large toys and other objects that could serve as steps for climbing out.
- Discontinue use of the product when child is able to climb out or reaches the height of 35 in. (89 cm), weighs more than 30lbs (14kg), or is able to climb out.
- **ALWAYS** provide the supervision necessary for the continued safety of your child. When used for playing, **NEVER** leave child unattended.
- **ALWAYS** place baby on back to sleep to reduce the risk of SIDS and suffocation.
- **NEVER** use this product if there are any loose or missing fasteners, loose joints, broken parts, or torn mesh/fabric. Check before assembly and periodically during use. Contact Chicco for replacement parts and instruction if needed. Never substitute parts.

Components

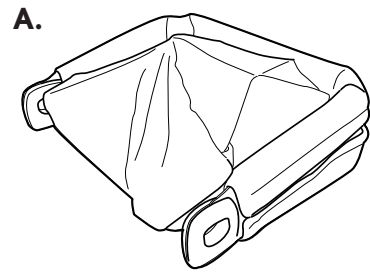

A. Playard Frame

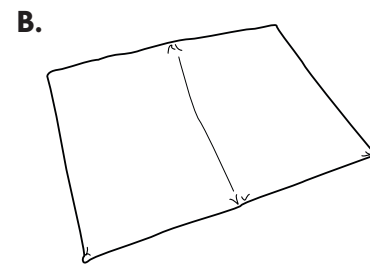

B. Playard Mattress

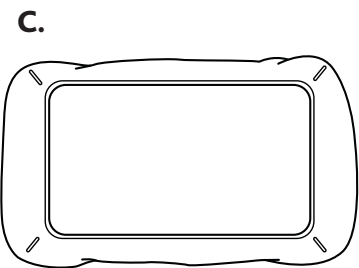

C. Playard Fitted Sheet
(assembled to Playard Mattress)

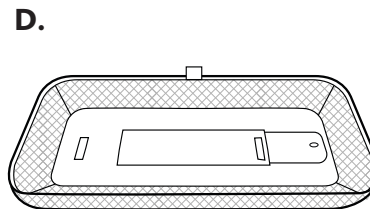

D. Bassinet

Components

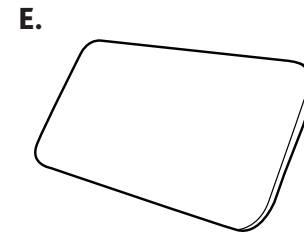

E. Bassinet Mattress

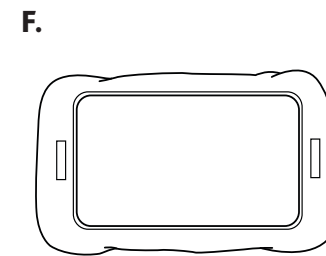

F. Bassinet Fitted Sheet
(assembled to Bassinet Mattress)



G. Carry Bag

Setting Up the Bassinet

⚠️ WARNING

Before use, remove and dispose of any plastic bags and keep them out of reach of children to avoid the danger of suffocation. Failure to follow these warnings and instructions could result in serious injury or death. This product requires adult assembly. Make sure all latches are locked and secure before use.

1

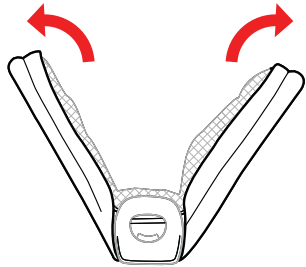

1. Remove Playard Frame from the Carry Bag.

Unfold the Frame until it locks into place. You should hear an audible click when the Frame is secure.



"CLICK!"

2

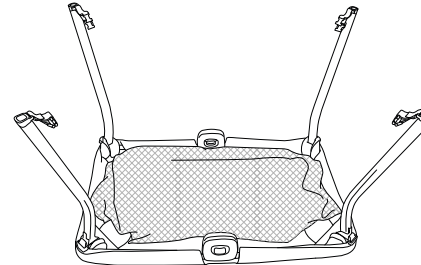

2. Lay the Playard Frame down with the legs facing up.

Pull each leg up until it locks into place. You should hear an audible click when each leg is secure.

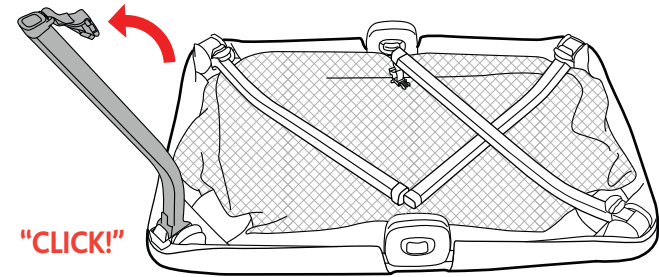

"CLICK!"

Setting Up the Bassinet

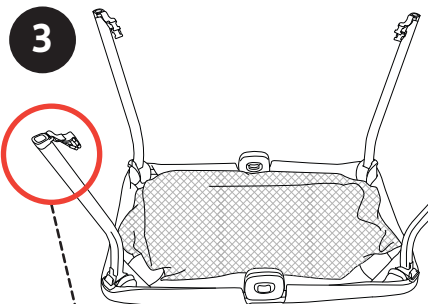

3. Attach all 4 clips on the bottom corners of the Playard Frame fabric to the clips on each of the legs.

Make sure the straps are not twisted and are secured properly.

Flip the Frame over.

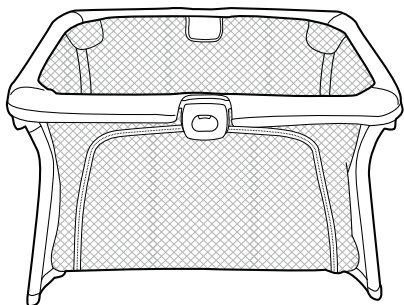
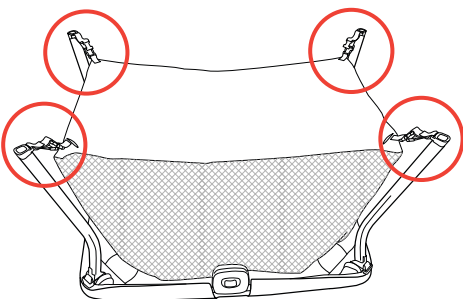
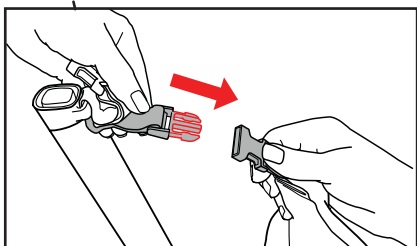

Setting Up the Bassinet

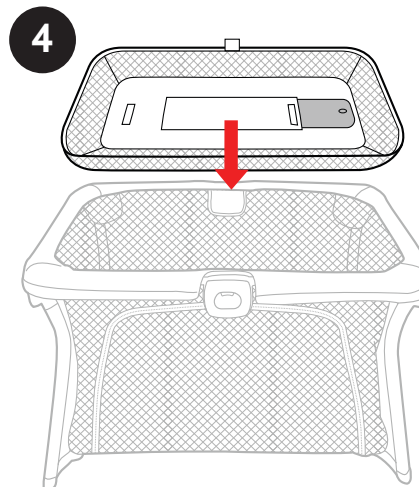

4. Insert the Bassinet into the Playard Frame and secure it with the zipper.

Then tuck the flap on the Bassinet into the handle cutout on the playard fabric.

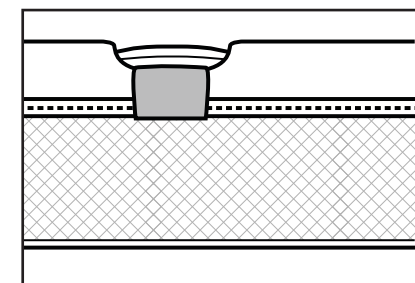
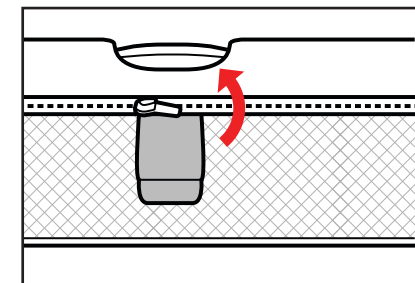
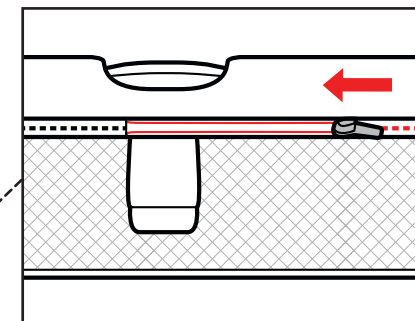
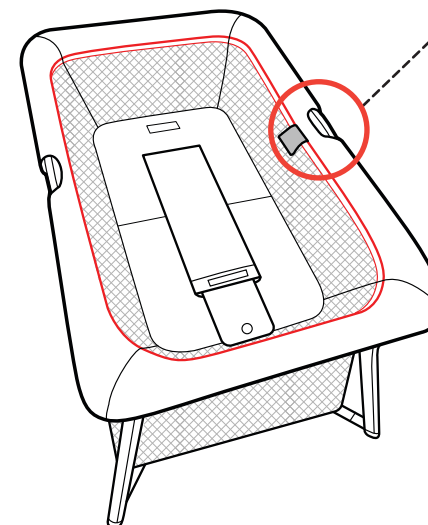

Setting Up the Bassinet

⚠ WARNING

PUSH board completely into the pocket and fasten before adding the mattress and using bassinet. **NEVER** use the bassinet without the mattress in place.

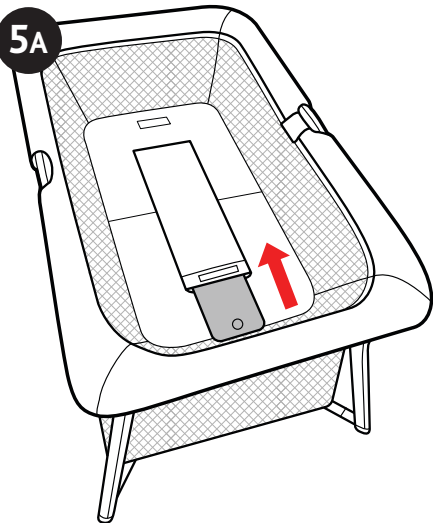

5A. Make sure the board on the floor of the Bassinet is completely pushed into the pocket and the pocket is fastened.

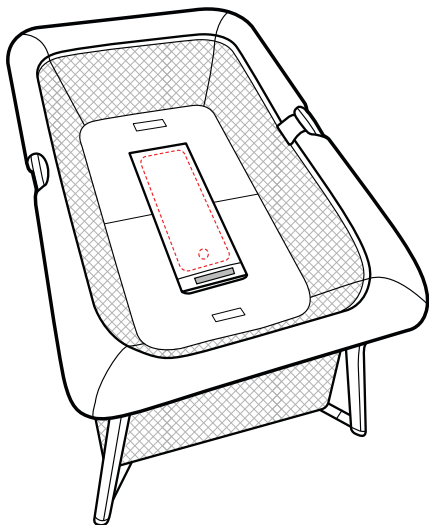

Setting Up the Bassinet

5B

5B. Place the Bassinet Mattress onto the floor of the Bassinet.

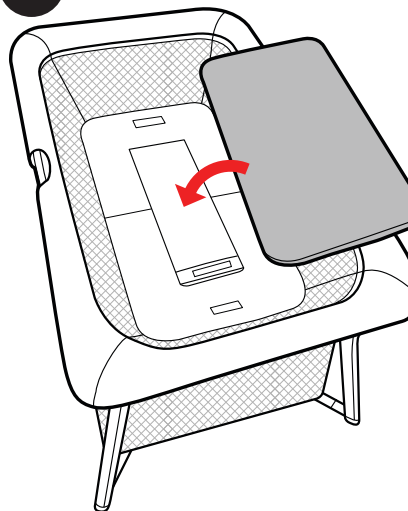

Packing up the Bassinet

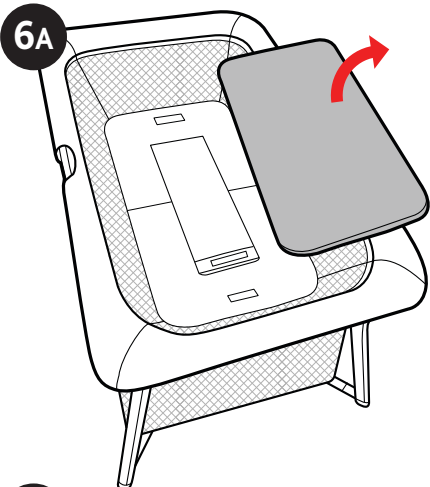

6A. Remove the Bassinet Mattress.

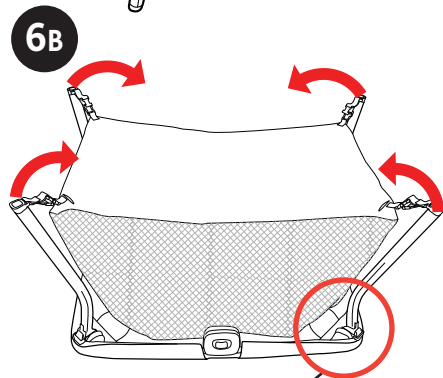

6B. Flip the playard over and locate the Release Button on the corners of the playard.

Push on the Release Button while at the same time pushing down on the bottom tab to unlock the leg. Fold the leg down.

Repeat this step for all legs.

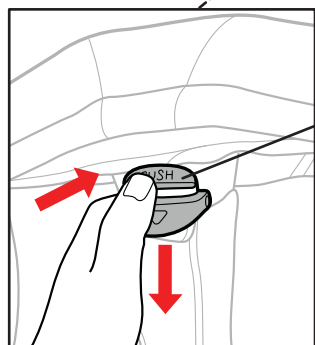

Release Button

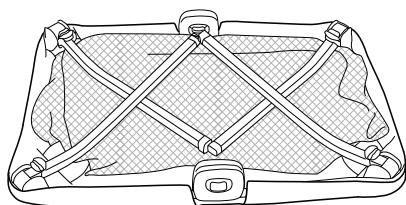

Packing up the Bassinet

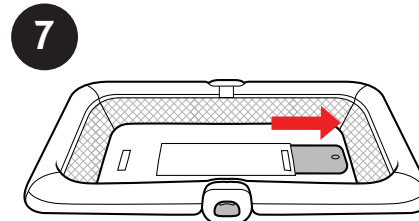

7. Flip the Frame over, with the legs facing down. Pull the board on the floor of the Bassinet halfway out.

Press in both Fold buttons located inside the Hubs on the Playard Frame.

Fold the Playard/Bassinet in half.

Place the Playard/Bassinet and folded Bassinet Mattress into the Carry Bag.

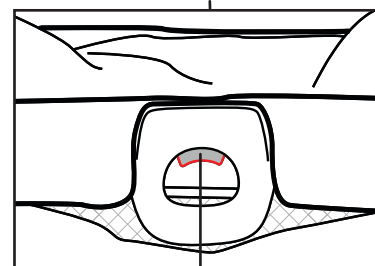
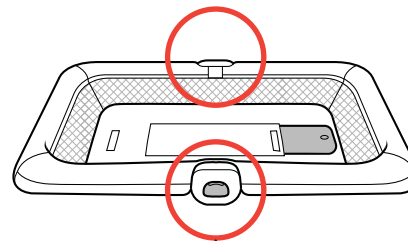

Fold Button

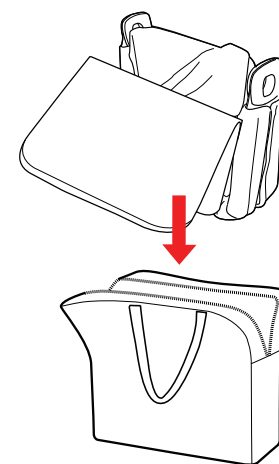
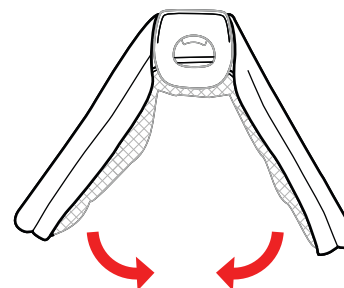

Setting Up the Playard

8

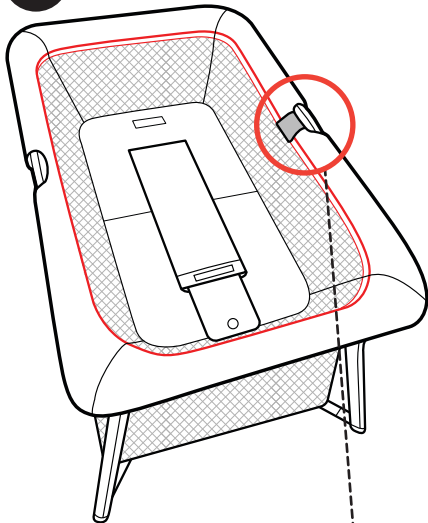

8. Remove the Bassinet Mattress. Undo the flap on the side of the Bassinet.

Unzip the Bassinet and remove it from the Playard Frame.

Undo the pocket fastener on the bottom of the Bassinet and pull the board halfway out.

Fold and store the Bassinet and the Bassinet Mattress.

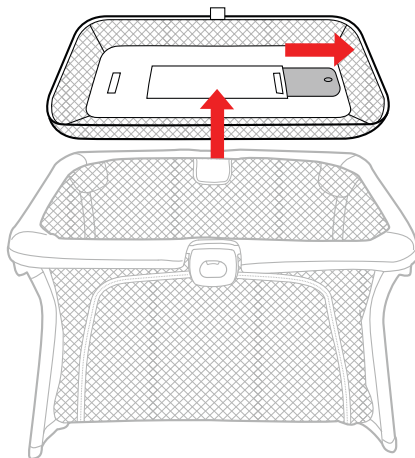
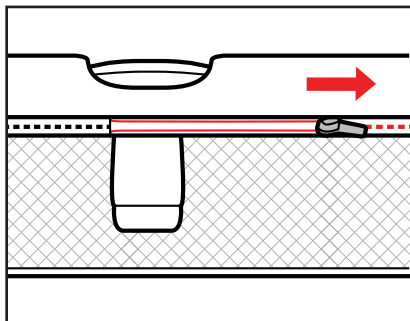
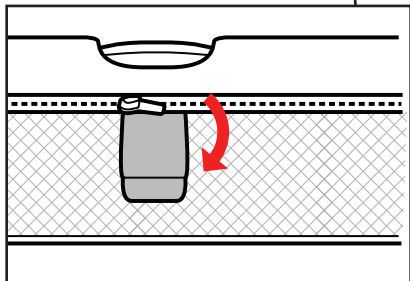

Setting Up the Playard

9

Bottom View

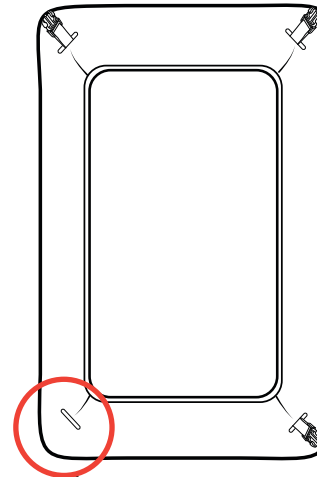

9. On the bottom of the Playard Mattress Pad, make sure to pull each strap through the openings on the Fitted Sheet, as shown.

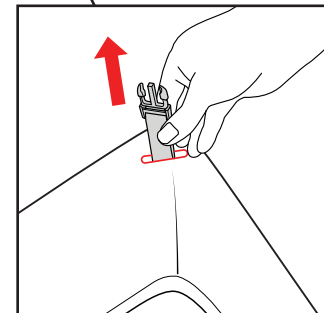

Setting Up the Playard

⚠️ WARNING

NEVER use the Playard without the Playard Mattress Pad in place.

10

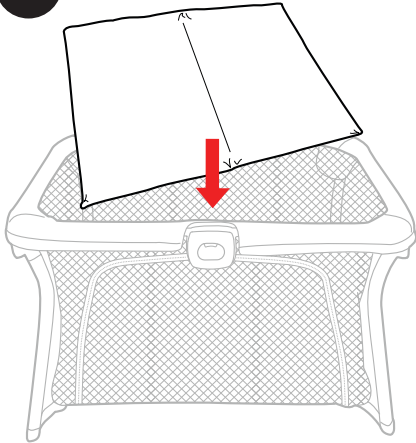

10. Insert the Playard Mattress Pad into the Playard Frame, padded side up.

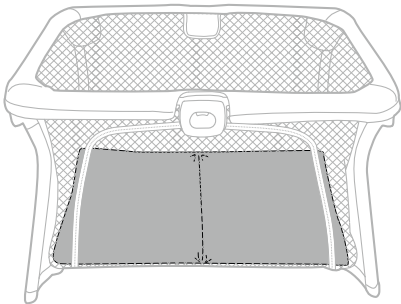

Setting Up the Playard

11A

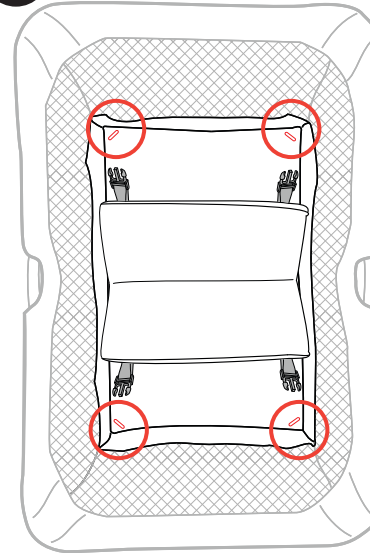

11A. Lift up the ends of the Playard Mattress Pad and locate 4 slots on the floor of the Playard.

11B

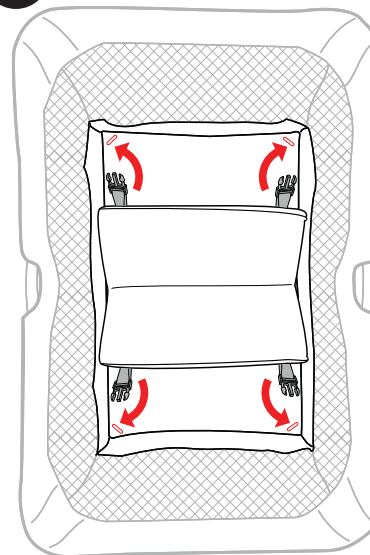

11B. Thread the 4 straps on the back of the Playard Mattress Pad through the slots on the floor of the Playard Frame.

Setting Up the Playard

12

Bottom View

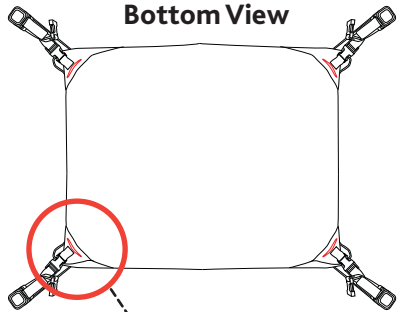

12. Pull the strap through the opening in the Playard floor. Bring together the mattress buckle and the white leg buckle to attach, as shown.

Repeat this step for the remaining 3 Mattress Pad Buckles.

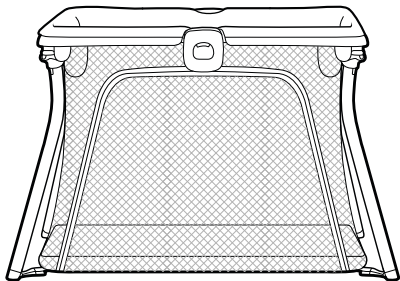
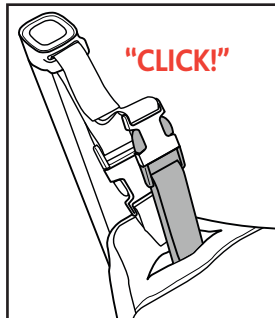
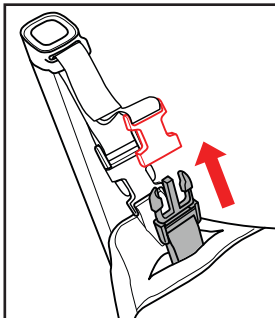
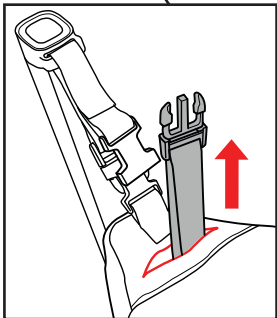

Converting to Play Area

13

13. To convert from a Playard to a play area, undo the Zipper Buckle, then unzip the door and tuck it under the Playard floor.

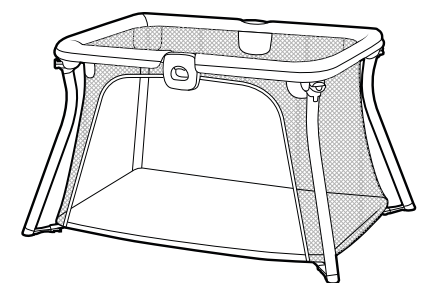
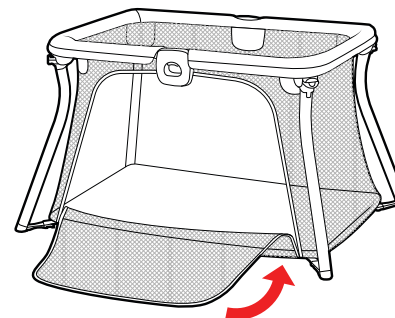
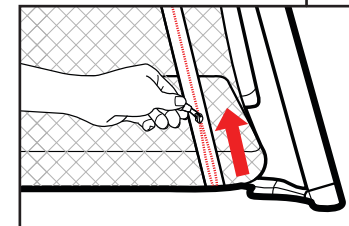
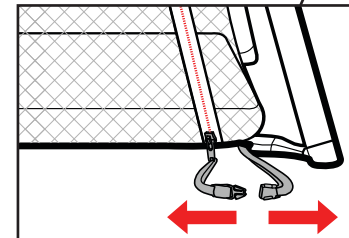
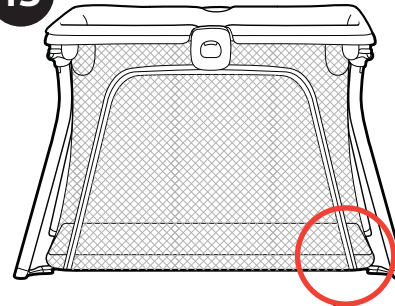

Packing up the Playard

14A

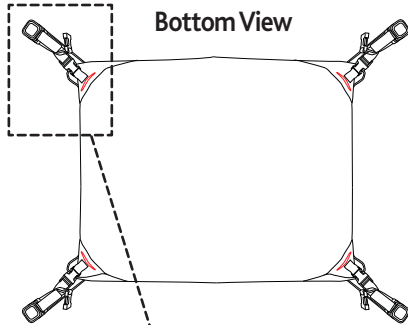

14A. Unbuckle all 4 Mattress Pad clips on the bottom of the Playard Frame, as shown.

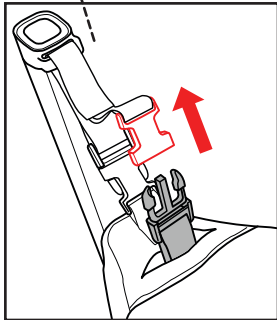

14B

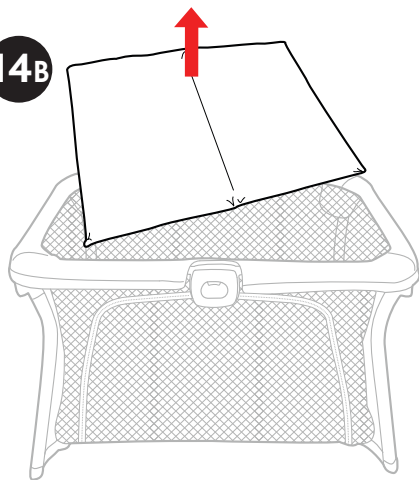

14B. Remove the Playard Mattress from the Playard Frame.

Packing up the Playard

15

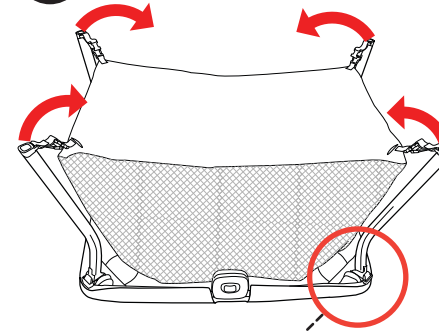

15. Flip the Playard over and locate the Release Button on the corners of the Playard.

Push on the Release Button while at the same time pushing down on the bottom tab to unlock the leg. Fold the leg down.

Repeat this step for all legs.

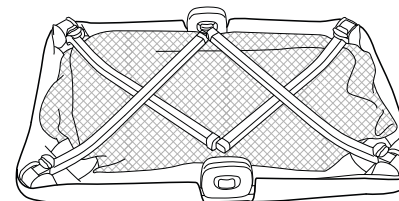
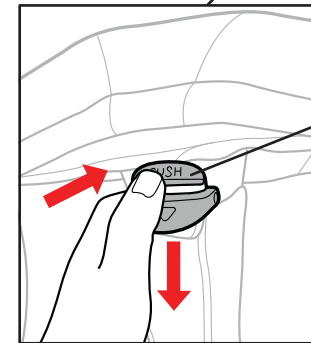

Packing up the Playard

16

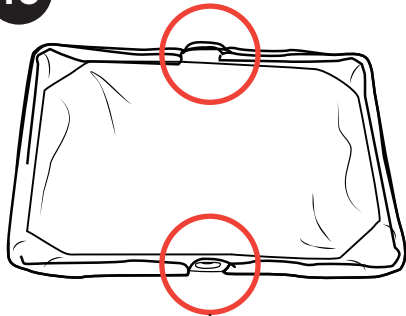

16. Flip the Frame over, with the legs facing down.

Press in both Fold buttons located inside the Hubs on the Playard Frame.

Fold the Playard Frame in half.

Place the Playard Frame and folded Playard Mattress into the Carry Bag.

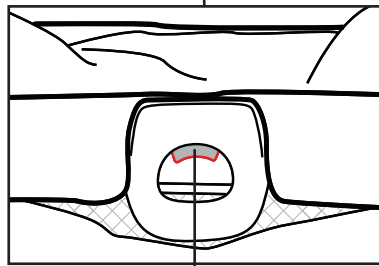

Fold
Button

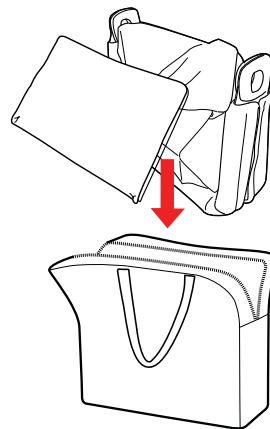
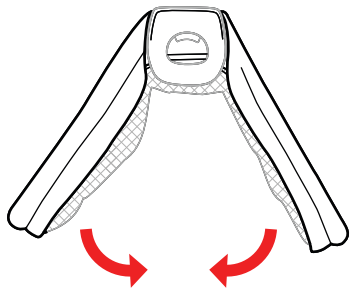

Storing the Instructions

17

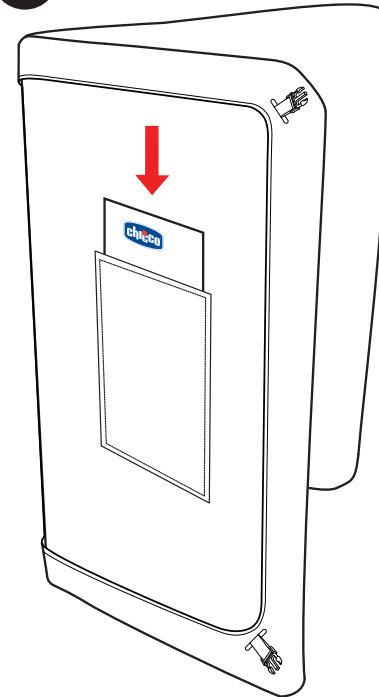

17. To keep instructions for future use: Place the manual in the storage sleeve located on the underside of the Playard Mattress Pad.

Playard Frame Fabric Removal

18

18. Locate the zipper under the top edge of the Playard Frame next to the folding hub.

Undo the the snap button on the safety straps, and then unzip both ends of the Playard fabric.

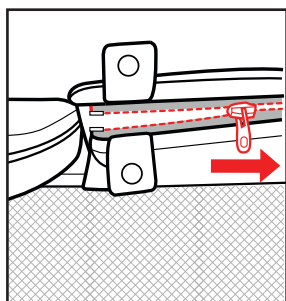
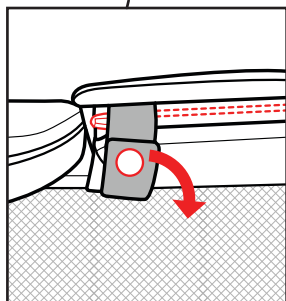
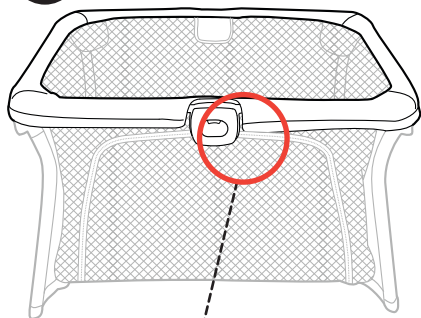

Playard Frame Fabric Removal

19

19. After both ends have been unzipped, undo all 4 snap buttons on each corner of the Playard.

The top portion of the zipper goes up and over the Frame, and the bottom portion of the zipper gets pulled down below the leg release button.

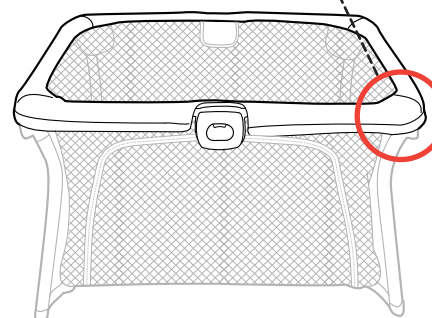
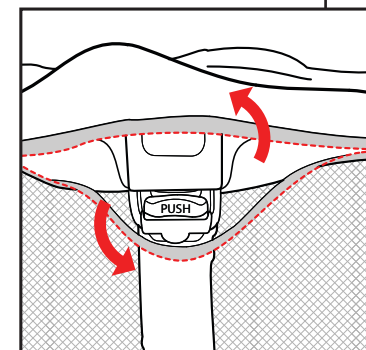
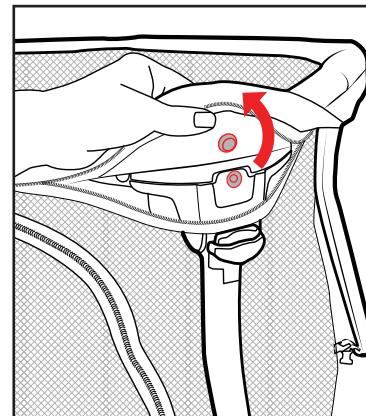

Playard Frame Fabric Removal

20

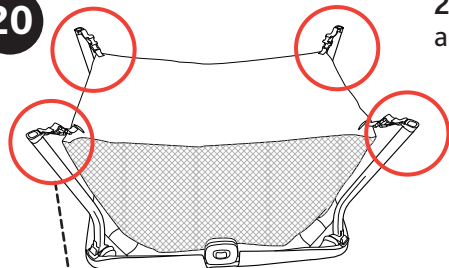

20. Flip the Playard Frame over and unclip the 4 fabric buckles.

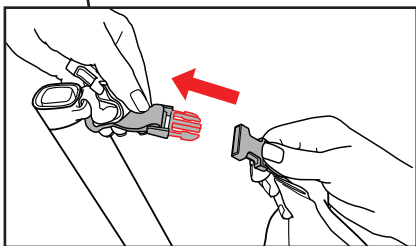

21

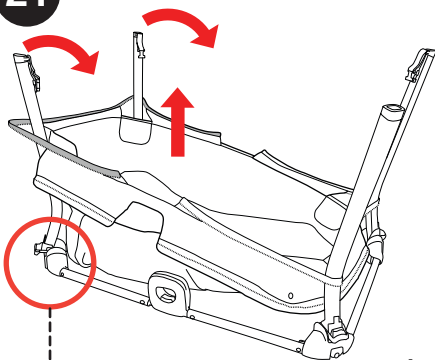

21. Turn the Playard Frame upside down. Then unlock 2 legs on one end of the playard, by pressing the Release Button.

Carefully remove the playard zipper fabric from around those legs.

Release Button

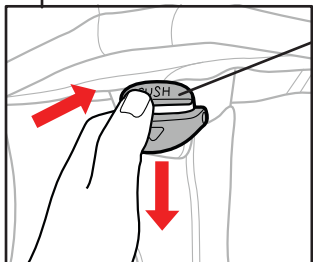

Playard Frame Fabric Removal

22

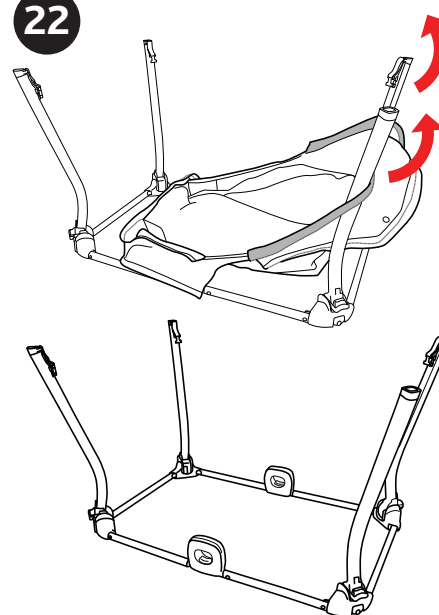

22. Carefully remove the fabric from around the other two legs.

Then remove the Playard Fabric completely.

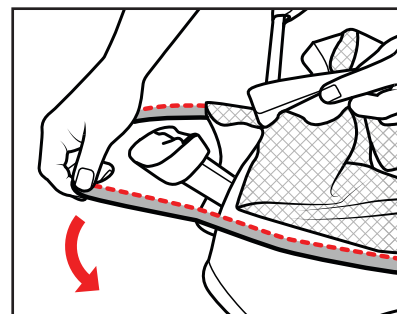

23. To reattach the Playard Frame Fabric complete steps 18-22 in REVERSE.

On Step 22 make sure to place the lower section of the zipper over each leg.

After the fabric has been zipped make sure safety straps near the zipper are snapped together.

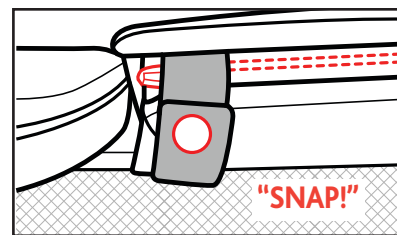

Fitted Sheet Removal

24

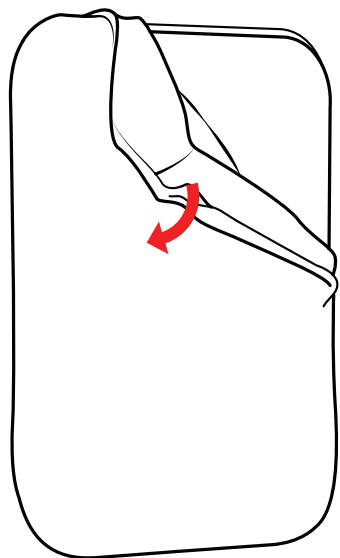

24. The fitted sheet on the Playard Mattress Pad and the Bassinet Mattress Pad can be removed for cleaning, as shown.

Cleaning and Maintenance

This product requires regular maintenance. The cleaning and maintenance of the playard must only be carried out by an adult.

The Playard softgoods, and Fitted Sheets can be washed following the instructions on the care labels. The waterproof mattress pads should not be washed, but can be wiped clean.

The Bassinet must be spot cleaned only.

CLEANING

Please refer to the care label for instructions on cleaning the fabric parts of the playard.

Periodically wipe clean plastic parts with a soft damp cloth. Always dry the metal parts to prevent the formation of rust if the playard has come into contact with water.

MAINTENANCE

Periodically check the playard for loose screws, worn parts, torn material or stitching. Replace or repair the parts as needed. Use only Chicco replacement parts. Keep the playard in a dry place. If playard becomes wet open playard and allow to dry completely. Prolonged exposure to direct sunlight may cause the fabric to fade and plastic parts to warp.

For More Information

If you have any questions or comments about this product, or are missing any of the parts please do not return this product to the store. Contact us in one of the following ways:



(877)-424-4226



info.usa@artsana.com



www.chiccousa.com



1826 William Penn Way
Lancaster, PA 17601

[**Kee-Ko**] If you say it right it makes you *smile*

