

**7 SHOULDER PADS:** To remove the Shoulder Pads undo the Velcro as shown.

**8 IMPORTANT!** If the Crotch Strap Pad prevents the harness from properly fitting a small Infant, remove immediately and store for future use.

**CROTCH STRAP PAD:** Unbuckle the Harness and remove Crotch Strap Pad by locating the Tab and pushing it through the Harness Buckle. Pull the Tab out through the front of the Harness Buckle and remove.

## CLEANING INSTRUCTIONS:

Fabrics may be spot-cleaned with mild soap and water, or machine washed in cold water on delicate cycle using mild detergent. Hang to dry. **DO NOT BLEACH.**

Please consult your product manual for instructions on additional care and maintenance instructions.



**WARNING:** Avoid serious injury or death to your child. Never use your KeyFit car seat without seat padding in place. You must read and understand the KeyFit Zip Softgoods Removal instructions **AND** the instructions in the User Guide. Keep these instructions. Fold instructions and store with the booklet in the KeyFit Base. If you do not understand these instructions, **DO NOT** attempt to remove the Softgoods, **STOP** and call Chicco at 1-877-424-4226.

## INSTRUCTIONS: KeyFit Zip Softgoods Removal

IMPORTANT: Please also refer to the instructions that came with your product.

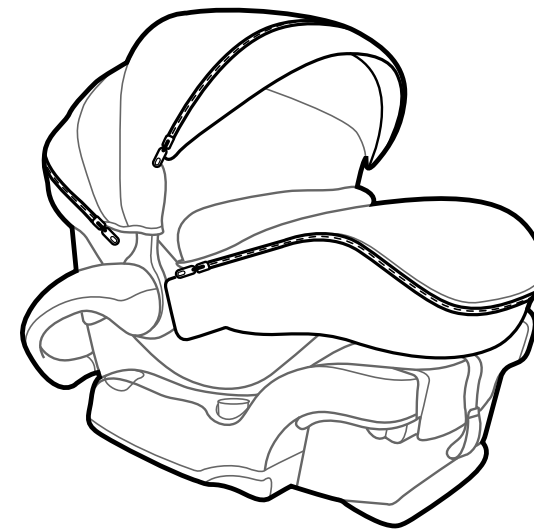

**PARTS LIST:**  
 A. Infant Insert    B. Headrest    C. Canopy Front    E. Crotch Strap Pad  
 D. Shoulder Pads    F. Boot Bottom

### TO REMOVE THE SEAT PAD:

Unzip the back Canopy zipper (**as shown**) and refer to User Guide to remove the Canopy. Remove the Boot (**See Steps 6a-6c**). Remove Shoulder Pads (**See Step 7**). Remove the Crotch Strap Pad (**See Step 8**). Remove the Headrest and Newborn Insert.

See Steps 1-5 to finish removing the Seat Pad.

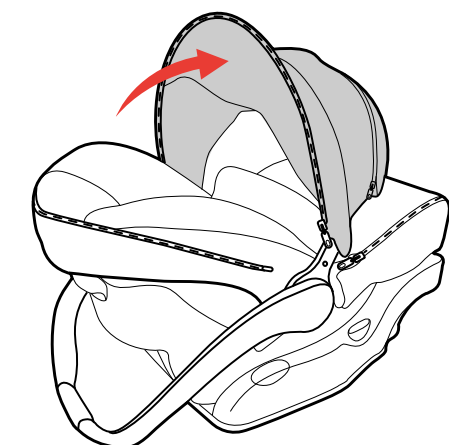
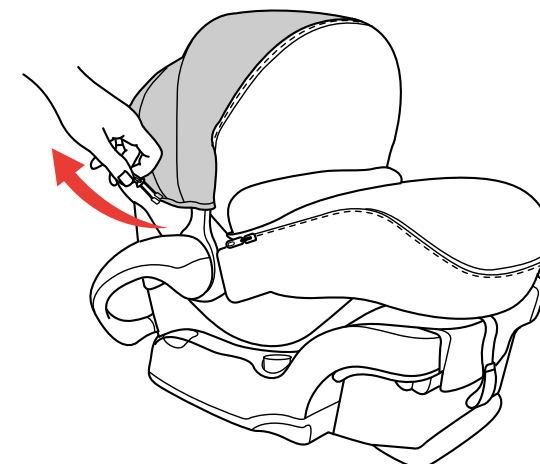

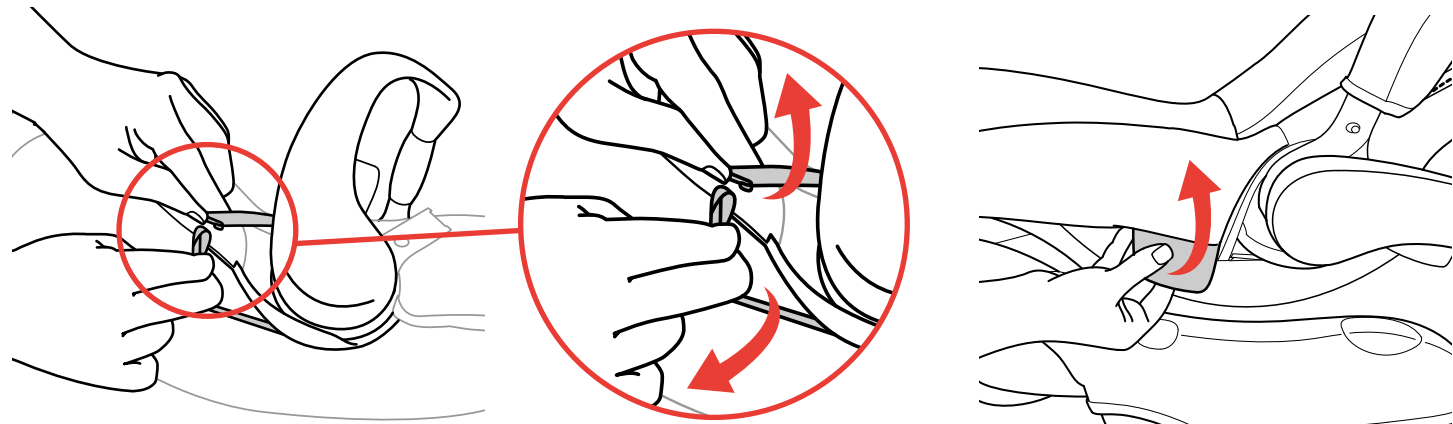

1a Unhook the elastic band attached around handle pivot, repeat for the other side.

1b Pull out plastic tabs located on both sides of the seat pad.

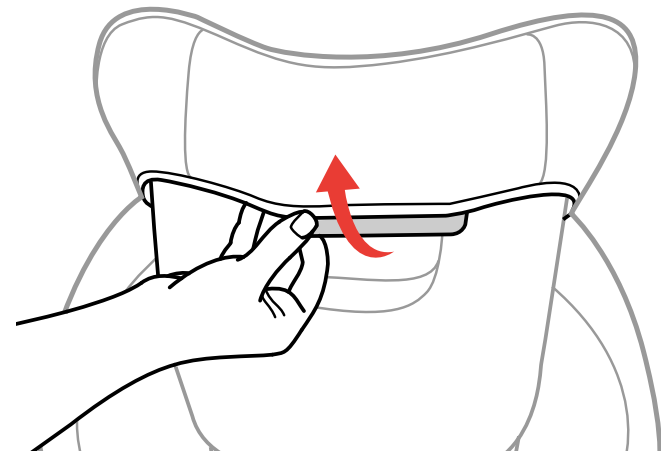

2 Pull out the Tab located on the back of the Seat Pad.

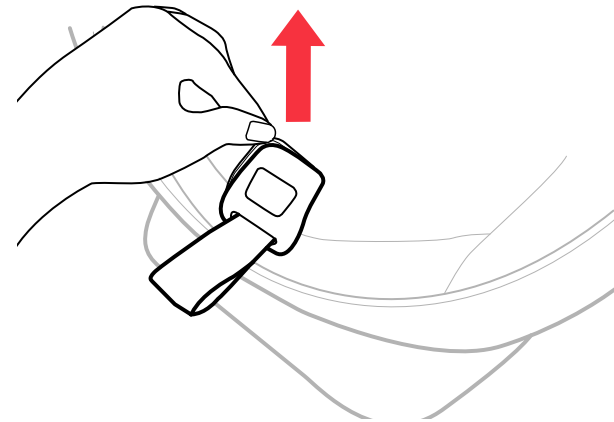

3 Pull Seat Pad away from the Adjuster Cover as shown.

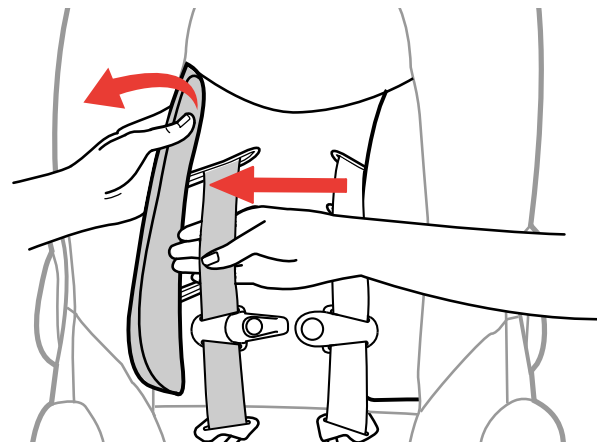

4 Pull the side of the Seat Pad up and slide the Harness Strap behind the Seat Pad at the shoulder and the waist, repeat for the other Harness Strap.

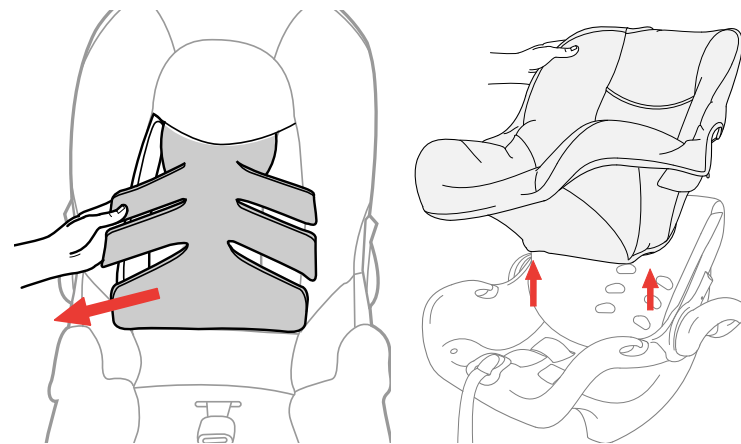

5 Make sure the Harness Straps are completely tucked behind the back of the Seat Pad and remove the Seat Pad.

**Make sure back piece of the Seat Pad is properly tucked into the softgoods when re-attaching the Seat Pad.**

**INSTALLATION OF THE KEYFIT ZIP WITHOUT A BASE:**

To access the Lap Belt guides unhook the Seat Pad covering the Lap Belt guide and tuck the padding under the softgoods, behind the Lap Belt guide as shown. Repeat for the other side.

Refer to page 37 in the KeyFit 30 user guide for installation instructions.

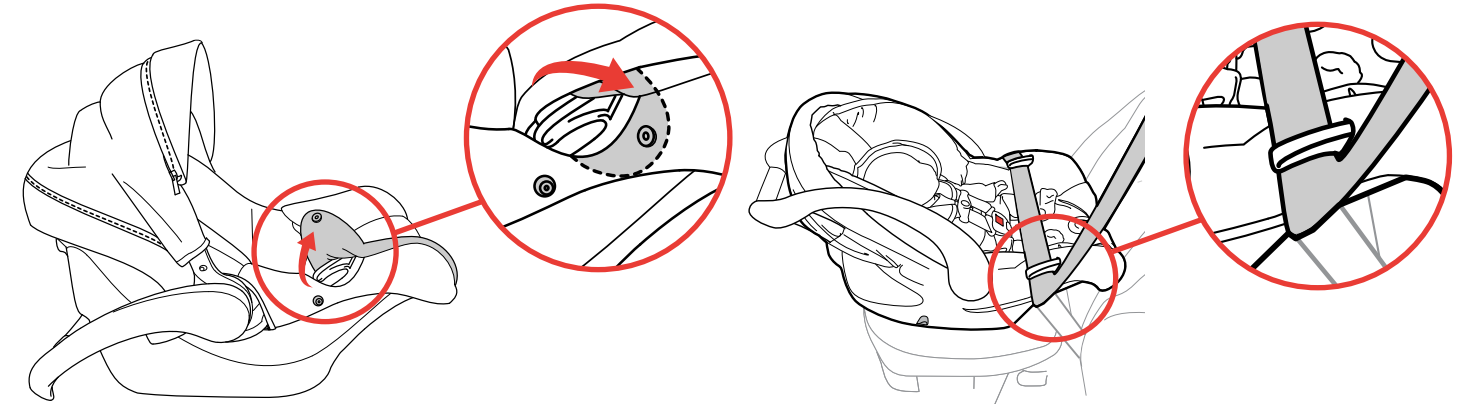

**REMOVING COMPONENTS:**

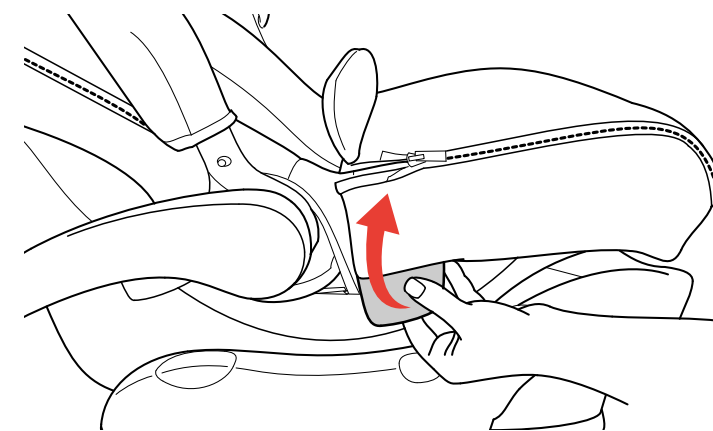

6a **BOOT:** To remove, pull out the Tab located on the side of Boot. Repeat for other side.

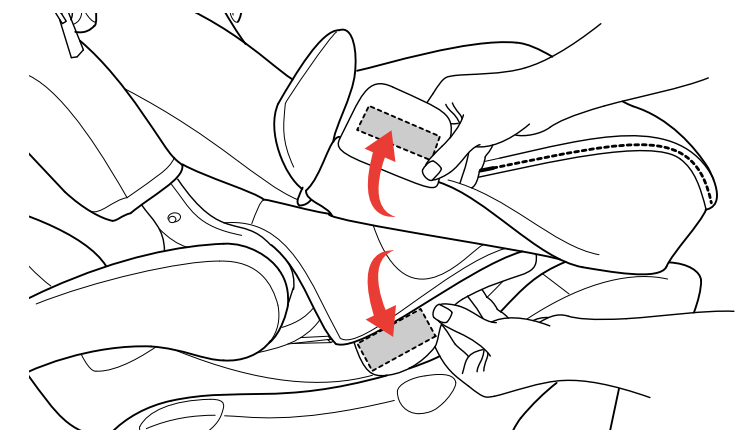

6b Unhook the Velcro on the Tab on both sides of the car seat as shown.

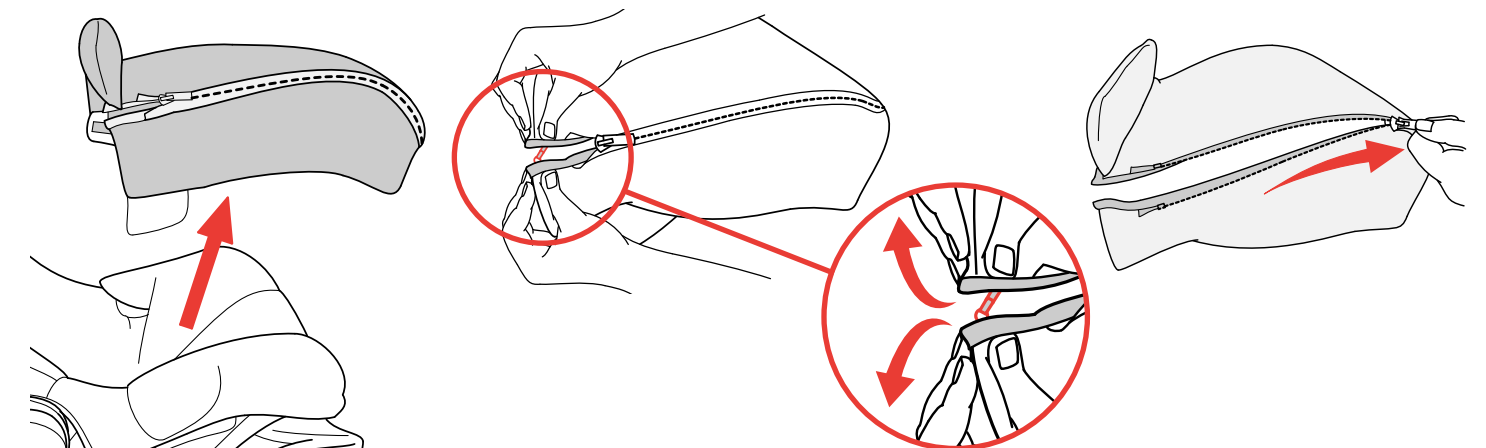

6c Remove the boot. Undo the hooks on both sides of the Boot and unzip to remove the top section.